

ALL PROPRIETARY RIGHTS RESERVED BY TOOLING 2000. THIS DRAWING SHALL NOT BE REPRODUCED OR IN ANY WAY UTILIZED FOR THE MANUFACTURE OF THE COMPONENT OR UNIT HEREIN DRAWN & MUST NOT BE RELEASED TO OTHER PARTIES WITHOUT WRITTEN CONSENT. INFRINGEMENT WILL BE LEGALLY PURSUED.

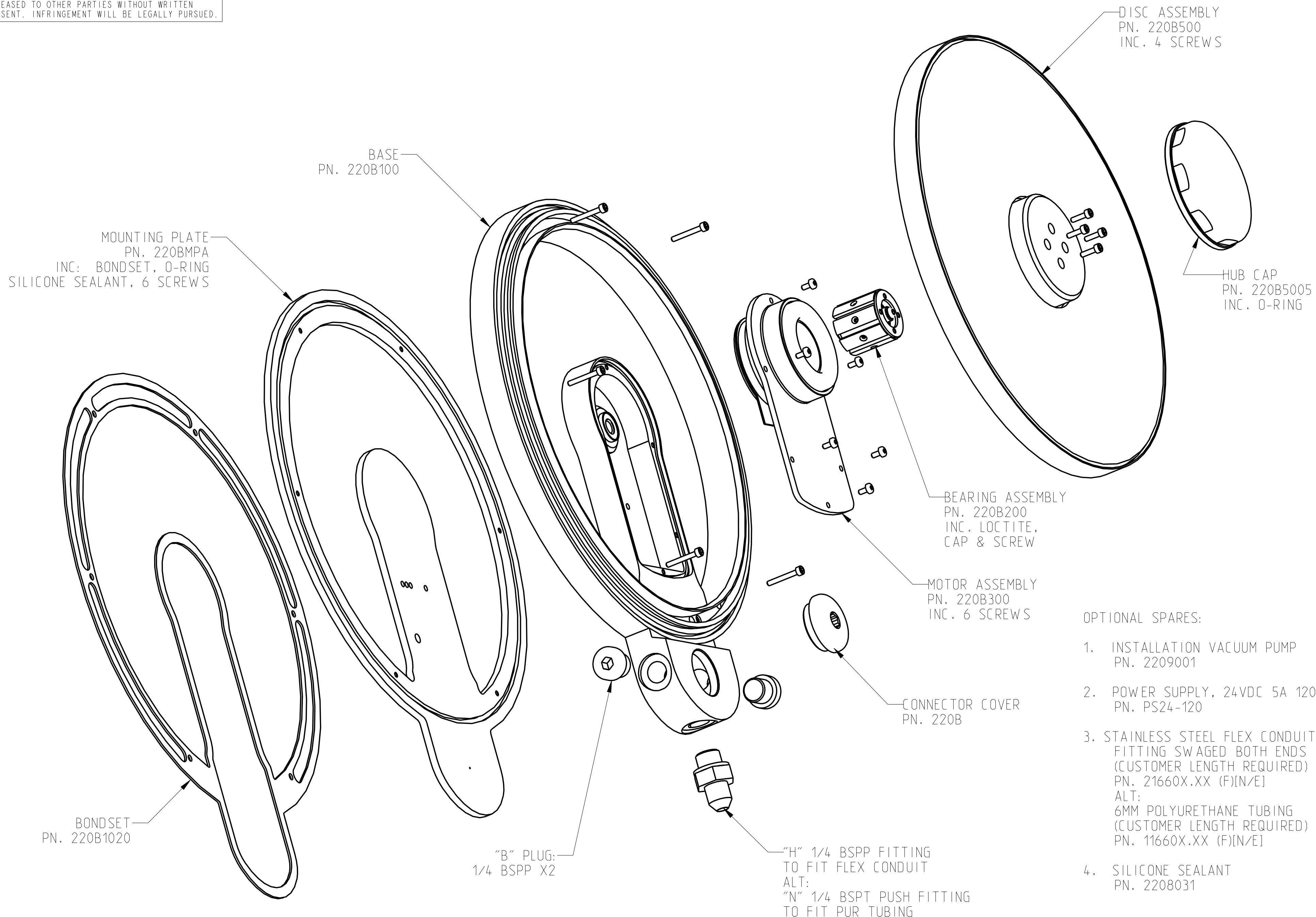

- OPTIONAL SPARES:
1. INSTALLATION VACUUM PUMP PN. 2209001
 2. POWER SUPPLY, 24VDC 5A 120W PN. PS24-120
 3. STAINLESS STEEL FLEX CONDUIT FITTING SWAGED BOTH ENDS (CUSTOMER LENGTH REQUIRED) PN. 21660X.XX (F)(N/E) ALT: 6MM POLYURETHANE TUBING (CUSTOMER LENGTH REQUIRED) PN. 11660X.XX (F)(N/E)
 4. SILICONE SEALANT PN. 2208031

SCALE 0.750

				VP 220B		TOOLING 2000	
				ASSY	CWS	XX.XX.02	220B EXPLODED
				NONE	WB	XX.XX.02	
A	PRODUCTION	08.11.03	CWS	.XX ±.01	WB	XX.XX.02	PRO-E/MODELS/12K/VP/220B
REV	DESCRIPTION	DATE	INT	.XXX ±.003	--	XX.XX.02	VP 220B
				ANGLE ±1°	DON	XX.XX.02	